

Interior Signage Package

Howard Johnson® by Wyndham



CONTACT

Bethany Nevels
National Sales Representative
423.364.4273 MOBILE
bethany.nevels@identitygroup.com

IDENTITY GROUP IS AN APPROVED SIGNAGE SUPPLIER

NO FEE* PROJECT SERVICES

- Estimating
 - Planning - Wayfinding
 - Project Management
 - Evacuation Map Development
- * Requires minimum project values

DESIGN SERVICES AVAILABLE



All products and services are provided by Identity Group and not Wyndham Hotels & Resorts (WH&R) or its subsidiaries. Neither WH&R nor its subsidiaries are responsible for the accuracy or completeness of any statements made in this advertisement, the content of this advertisement (including the text, representations and illustrations) or any material on the listed supplier's website to which the advertisement provides a link or a reference. Please refer to the applicable brand standards for your property prior to purchasing products.

Rev. 02-27-20

COLOR OPTIONS

The Howard Johnson® Standard Sign Package features 1/8" thick photopolymer sign faces, finished in your choice of the colors below.



Orange



Turquoise



Brown



White



PLEASE NOTE: All signage in this document is shown in orange, but all sign types are available in all four color scheme options.

GUEST ROOM SIGNAGE



RMN0503 HJ
Guest Room Number
5" x 3"



NS11
No Smoking
Clear Decal with
White Symbol
1-1/4" x 1-1/4"



AC11
Accessible
Clear Decal with
White Symbol
1-1/4" x 1-1/4"

IDENTIFICATION SIGNAGE



ID0904 HJ
1-2 Line Room ID
(Public/Guest Use)
9" x 4"



ID0907 HJ
Room ID with Hours Information
9" x 6-1/2"



ID0704 HJ
1-2 Line Room ID
(Non-Public / Back of House)
7" x 4"

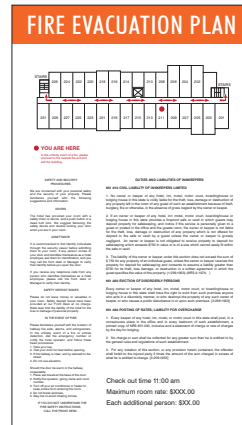

FEP0916 HJ
Guest Room
Fire Evacuation Plan
with State Lodging Laws
9" x 16"



STR0708 HJ
Stair ID (Corridor)
7" x 8"



ACC0708 HJ
Area of Rescue Assistance
7" x 8"

FORMERLY GRAPHICSSYSTEMS



Interior Signage Package

Howard Johnson® by Wyndham

INTERIOR STAIRWELL SIGNAGE

IDENTIFICATION SIGNAGE *cont.*



RR0708 HJ
Restroom ID
7" x 8"



STR1518 HJ
Interior Stairwell Sign
with Exit Discharge Information
14-1/2" x 18"



STR0903 HJ
Interior Stairwell Level ID
8-1/2" x 3"

INFORMATIONAL SIGNAGE

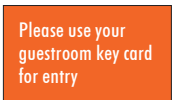

INF0704 HJ
Informational - Small
7" x 4"



INF0707 HJ
Informational - Medium
7" x 6-1/2"

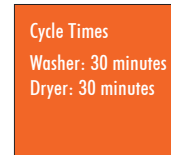

NOTE: Copy and layout of informational signs may vary as needed.



OWN1209 HJ
Owner / Operator Info with
Manager on Duty
12" x 8-3/4"

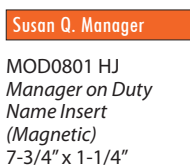

INF1209 HJ
Front Desk Info / Large Informational
12" x 8-3/4"

FIRE CODE / EVACUATION SIGNAGE

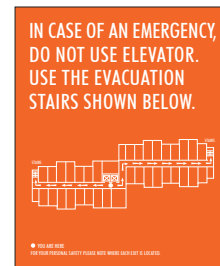

FEP0911 HJ
Elevator Fire Evacuation
Plan with Map
9" x 11"



ICO0911 HJ
In Case of Fire
9" x 11"

DIRECTIONAL SIGNAGE

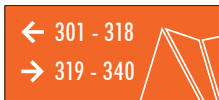

DIR0904 HJ
1-2 Line Directional
(Narrow)
9" x 4"



DIR1204 HJ
1-2 Line Directional (Wide)
12" x 4"



DIR1209 HJ
5-6 Line Directional (Wide)
12" x 8-3/4"



DIR1211 HJ
7-8 Line Directional (Wide)
12" x 11"



DIR0907 HJ
3-4 Line Directional
(Narrow)
9" x 6-1/2"



DIR1207 HJ
3-4 Line Directional (Wide)
12" x 6-1/2"

NOTE: Additional sizes of directionals are available if needed.

FORMERLY GRAPHICSSYSTEMS

IDENTITY GROUP

Interior Signage Package

Howard Johnson® by Wyndham

PARKING AREA SIGNAGE



PRK1218 HJ
Parking Liability Notice
12" x 18"



PRK1218B HJ
Accessible Parking
12" x 18"



PRK1218C HJ
Van Accessible Parking
12" x 18"



VPRK 1218 HJ
Veteran Reserved Parking
12" x 18"

USA



Canada - English

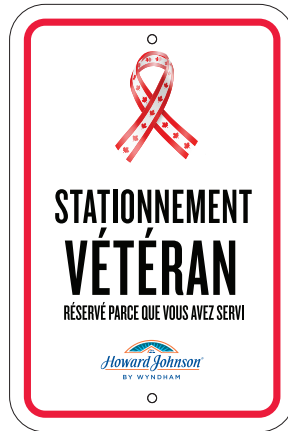

Canada - French



WR PRK 1218
Wyndham Rewards Reserved Parking
12" x 18"

CLEARANCE: 8' - 10"

CLR4208 HJ
Clearance Height
42" x 8"

FORMERLY GRAPHICSystems

IDENTITY GROUP

Interior Signage Package

Howard Johnson® by Wyndham

POOL & SPA AREA SIGNAGE

POOL RULES

1. Pool for guest use only.
2. Food and glass objects are not permitted in pool area.
3. Excessive noise will not be permitted.
4. Pets are not allowed in pool area.
5. Children under 12 years of age must be accompanied by an adult.
6. No running or diving.
7. No lifeguard on duty.
8. Management reserves the right to deny pool usage to anyone at anytime.
9. Use pool at your own risk.

POOL HOURS: 7:00 am to 11:00 pm

POL1622 HJ
Pool Rules
16" x 22"

SPA RULES

1. Spa for guest use only.
2. Food and glass objects are not permitted in spa area.
3. Excessive noise will not be permitted.
4. Pets are not allowed in the spa area.
5. Children under 12 years of age must be accompanied by an adult.
6. CAUTION: Guests with the following conditions should not use the spa without doctor's permission:
 - Heart disease.
 - Diabetic.
 - On medication.
 - Pregnant.
 - High or low blood pressure.
7. Do not exceed 15 minutes continuous in spa.
8. Management reserves the right to deny spa usage to anyone at anytime.
9. Use spa at your own risk.

SPA1622 HJ
Spa Rules
16" x 22"

FITNESS CENTER RULES

1. Individuals utilizing this facility do so at their own risk.
2. It is highly recommended that the following individuals not use the exercise equipment.
 - persons under the influence of alcohol, stimulants or depressants
 - unsupervised children under the age of 16
 - children under the age of 14
3. Should you need any assistance please contact the Front Desk.
4. Equipment should be used in the presence of others.
5. Shoes and appropriate exercising attire are necessary.
6. Smoking is prohibited.
7. Always practice safety and courtesy to others.
8. Report any unsafe conditions to the management.

FIT1622 HJ
Fitness Center Rules
16" x 22"

NO LIFEGUARD
ON DUTY

NLG3212 HJ
No Lifeguard on Duty
32" x 12"

NO DIVING



ND3208 HJ
No Lifeguard on Duty
32" x 8"

PLEASE NOTE:

State and local codes may require your pool and spa area signage to have certain text, layouts and copy sizes specific to your area.

If code-related signs are needed for your project, we will quote them in place of the brand standard signs.

FORMERLY GRAPHICSSYSTEMS

IDENTITY
GROUP