

# Interior Sign Package

Suburban Extended Stay



## CONTACT

Cindy Train  
316.267.4171 x202  
316.267.6883 FAX  
cindy.train@identitygroup.com

**IDENTITY GROUP IS AN APPROVED SIGNAGE SUPPLIER**

## NO FEE\* PROJECT SERVICES

- Estimating
  - Planning - Wayfinding
  - Project Management
  - Evacuation Map Development
- \* Requires minimum project values

## DESIGN SERVICES AVAILABLE

## COLORS / MATERIALS

MaintStay Suites Standard Sign Package Features your Choice of 2 Color options Shown Below.

### Standard

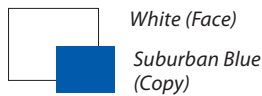

Standard Option is Shown in this Brochure

### Alternate

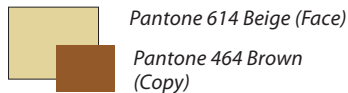

Sign Materials: Painted Photopolymer and Acrylic with Screen Printed Graphics.

Font: Futura Medium, Bold & Bold Condensed

Rev. 01-25-19

## GUEST ROOM SIGNAGE



RMN0604 SUB  
Large Guest Room  
Number  
6" x 4"



RMN0503 SUB  
Small Guest Room  
Number  
4-1/2" x 3"

- Accessible
- No Smoking
- Hearing Impaired

ACC0202 SUB  
Accessible Symbols  
1-1/2" x 1-1/2"

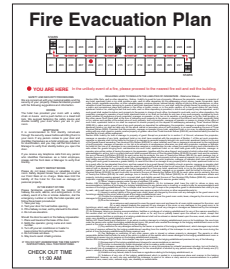

FEP0911 CHO  
Guest Room Evacuation  
with State Laws  
8-1/2" x 11"

## IDENTIFICATION SIGNAGE



ID0604 SUB  
1-2 Line Room  
Identification  
6" x 4"



STRO506 SUB  
Stair Identification  
4-1/2" x 6"



RES0609 SUB  
Restroom Identification  
6" x 9"

## INFORMATIONAL SIGNAGE



FEP0811A SUB  
Elevator Fire Evacuation  
Plan, Ground Floor  
8" x 10-3/4"



INF0911 SUB  
Hours Informational  
9" x 11"



INF0605 SUB  
Informational  
6" x 4-1/2"



KEY0504 SUB  
Key Card  
5" x 4"



FEP0202 SUB  
Fire Extinguisher Symbols  
2" x 2"

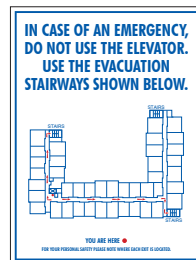

FEP0811B SUB  
Elevator Fire Evacuation  
Plan, Upper Floors  
8" x 10-3/4"



PRK0910 SUB  
Parking Informational  
9" x 10"



OWN1014 SUB  
Owner/Operator Informational  
10" x 14"

# Interior Sign Package

Suburban Extended Stay

## DIRECTIONAL SIGNAGE



DIR0805 SUB  
1-2 Line Directional  
8" x 4-1/2"



DIR0807 SUB  
3-4 Line Directional  
8" x 6-3/4"

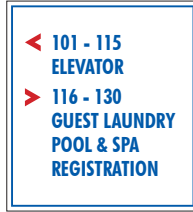

DIR0809 SUB  
5-6 Line Directional  
8" x 8-3/4"

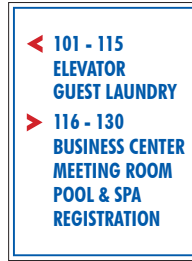

DIR0811 SUB  
7-8 Line Directional  
8" x 10-3/4"



DIR1812 SUB  
Large Exterior Directional  
18" x 12"

## POOL AND SPA SIGNAGE

### POOL AREA USE

**FOR YOUR SAFETY, IT IS REQUIRED THAT YOU OBSERVE THE FOLLOWING:**

- REGISTERED GUESTS ONLY.
- ALL CHILDREN UNDER 14 MUST BE WITH AN ADULT.
- RUNNING AND HORSEPLAY ARE PROHIBITED.
- APPROPRIATE SWIM WEAR REQUIRED.
- DIVING STRICTLY PROHIBITED.
- SHIRTS AND SHOES REQUIRED IN THE HOTEL LOBBY.
- GLASSWARE IS NOT PERMITTED WITHIN THE POOL AREA.
- ONLY FLEXIBLE SWIM-AIDS ARE PERMITTED.
- BE AWARE OF DEPTH MARKINGS AT ALL TIMES.
- REPORT ANY UNSAFE CONDITIONS OR VIOLATIONS TO THE MANAGEMENT IMMEDIATELY.
- INDIVIDUALS ASSUME THE RISK FOR ANY INJURIES SUSTAINED WHILE USING POOL FACILITIES.
- ALWAYS PRACTICE WATER SAFETY AND COURTESY.
- SHOWER BEFORE ENTERING POOL.
- CHILDREN WHO ARE NOT TOILET TRAINED MUST WEAR SWIM DIAPERS WITH RUBBER PANTS OVER THEM.

THANK YOU FOR YOUR ATTENTION AND COOPERATION.

POL2420 SUB  
Pool Area Use  
23-1/2" x 20"

### WHIRLPOOL SPA USE

**FOR YOUR SAFETY, IT IS REQUIRED THAT YOU OBSERVE THE FOLLOWING:**

- REGISTERED GUESTS ONLY.
- INDIVIDUALS UTILIZING THIS FACILITY DO SO AT THEIR OWN RISK.
- WARNING - NO CONSUMPTION OF ALCOHOLIC BEVERAGES OR FOOD IS PERMITTED IN POOL AREA.
- IT IS HIGHLY RECOMMENDED THAT THE FOLLOWING INDIVIDUALS NOT USE THE WHIRLPOOL SPA: A) PERSONS WITH PRESENT OR PRIOR HEART DISEASE, HIGH BLOOD PRESSURE, OR ANY CHRONIC HEALTH PROBLEMS. B) PERSONS UNDER THE INFLUENCE OF ALCOHOL, STIMULANTS OR DEPRESSANTS. C) PREGNANT WOMEN. D) ELDERLY PERSONS. E) CHILDREN UNDER THE AGE OF 10. F) UNSUPERVISED CHILDREN UNDER THE AGE OF 15.
- SHOULD YOU NEED ANY ASSISTANCE, PLEASE CONTACT MANAGEMENT.
- WARNING: CHEMICAL AND PH LEVELS ARE IN ACCORDANCE WITH LOCAL CODES AND MEASURED REGULARLY. HOWEVER, HIGH HEAT AND CHEMICAL IN THIS SPA MAY CAUSE FADING AND/OR DAMAGE TO CERTAIN FABRICS.
- ALWAYS PRACTICE WATER SAFETY AND COURTESY TO OTHERS.
- REPORT ANY UNSAFE CONDITIONS TO THE MANAGEMENT.
- ALL PERSONS SHALL BATHE WITH WARM WATER AND SOAP BEFORE ENTERING SPA.
- ANY PERSONS KNOWN OR SUSPECTED OF HAVING A COMMUNICABLE DISEASE SHALL NOT USE SPA.
- SPITTING OR BLOWING THE NOSE IN THE SPA IS PROHIBITED.
- DO NOT USE ALONE.
- OBSERVE A REASONABLE TIME LIMIT, (PREFERABLY NOT LONGER THAN 15 MINUTES), THEN SHOWER, COOL DOWN AND IF YOU WISH, RETURN FOR ANOTHER BRIEF STAY. LONG EXPOSURES MAY RESULT IN NAUSEA, DIZZINESS OR FAINTING.
- FOOD AND GLASS OBJECTS ARE NOT PERMITTED IN SPA AREA.
- MAXIMUM TEMPERATURE 104° FAHRENHEIT.

MAXIMUM BATHING LOAD

THANK YOU FOR YOUR ATTENTION AND COOPERATION.

SPA2422 SUB  
Spa Area Use  
23-1/2" x 22"

## POOL

**OPERATING HOURS:  
8:00 AM TO 10:00 PM**

**GLASS IS NOT PERMITTED  
IN THE POOL AREA**

**POOL IS FOR CUSTOMERS  
AND THEIR GUESTS ONLY**

POL1820 SUB  
Pool Hours  
Informational  
18" x 20"



POL1818 SUB  
No Diving Pool  
18" x 18"

# Interior Sign Package

Suburban Extended Stay

## POOL AND SPA SIGNAGE *cont.*

**NO LIFEGUARD  
ON DUTY  
NO DIVING**

POL4830 SUB  
*No Lifeguard Pool*  
47-1/2" x 30"

**PLEASE NOTE:** State and local codes may require your pool and spa area signage to have certain text, layouts and copy sizes specific to your area. If code-related signs are needed for your project, we will quote them in place of the brand standard signs.

## LOBBY LOGO



LOG3529 SUB  
*Lobby Logo*  
35" x 29-1/4"

Shown In Brushed Gold

Four Color Options Available:  
Brushed Gold, Brushed Silver,  
Polished Gold & Polished Silver

