

# Interior Signage Package

Howard Johnson® by Wyndham



## CONTACT

Daina Bailey  
316.267.4171 OFFICE  
316.267.6883 FAX  
daina.bailey@identitygroup.com

**IDENTITY GROUP IS AN APPROVED SIGNAGE SUPPLIER**

## NO FEE\* PROJECT SERVICES

- Estimating
  - Planning - Wayfinding
  - Project Management
  - Evacuation Map Development
- \* Requires minimum project values

## DESIGN SERVICES AVAILABLE



All products and services are provided by Identity Group and not Wyndham Hotels & Resorts (WH&R) or its affiliates. Neither WH&R nor its affiliates are responsible for the accuracy or completeness of any statements made in this advertisement, the content of this advertisement (including the text, representations and illustrations) or any material on the listed supplier's website to which the advertisement provides a link or a reference. Please refer to the applicable brand standards for your property prior to purchasing products.

## COLOR OPTIONS

The Howard Johnson® Standard Sign Package features 1/8" thick photopolymer sign faces, finished in your choice of the colors below.



Orange



Turquoise



Brown



White



PLEASE NOTE: All signage in this document is shown in orange, but all sign types are available in all four color scheme options.

## GUEST ROOM SIGNAGE



RMN0503 HJ  
Guest Room Number  
5" x 3"



NS11  
No Smoking  
Clear Decal with  
White Symbol  
1-1/4" x 1-1/4"



AC11  
Accessible  
Clear Decal with  
White Symbol  
1-1/4" x 1-1/4"

## IDENTIFICATION SIGNAGE



ID0904 HJ  
1-2 Line Room ID  
(Public/Guest Use)  
9" x 4"



ID0907 HJ  
Room ID with Hours Information  
9" x 6-1/2"



ID0704 HJ  
1-2 Line Room ID  
(Non-Public / Back of House)  
7" x 4"



STR0708 HJ  
Stair ID (Corridor)  
7" x 8"



ACC0708 HJ  
Area of Rescue Assistance  
7" x 8"

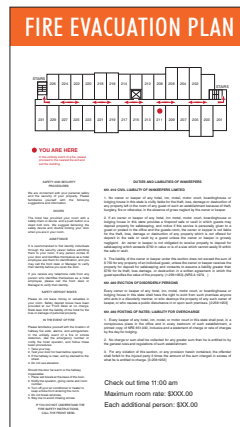

FEP0916 HJ  
Guest Room  
Fire Evacuation Plan  
with State Lodging Laws  
9" x 16"

# Interior Signage Package

Howard Johnson® by Wyndham

## INTERIOR STAIRWELL SIGNAGE

### IDENTIFICATION SIGNAGE *cont.*



RR0708 HJ  
Restroom ID  
7" x 8"



STR0903 HJ  
Interior Stairwell Level ID  
8-1/2" x 3"

STR1518 HJ  
Interior Stairwell Sign  
with Exit Discharge Information  
14-1/2" x 18"

### INFORMATIONAL SIGNAGE

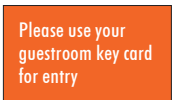

INF0704 HJ  
Informational - Small  
7" x 4"



INF0707 HJ  
Informational - Medium  
7" x 6-1/2"

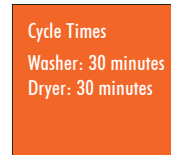

NOTE: Copy and layout of informational signs may vary as needed.

### FIRE CODE / EVACUATION SIGNAGE



OWN1209 HJ  
Owner / Operator Info with  
Manager on Duty  
12" x 8-3/4"

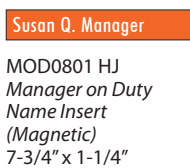

INF1209 HJ  
Front Desk Info / Large Informational  
12" x 8-3/4"

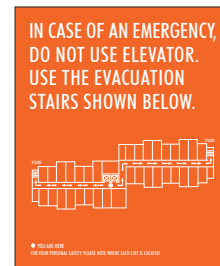

FEP0911 HJ  
Elevator Fire Evacuation  
Plan with Map  
9" x 11"



ICO0911 HJ  
In Case of Fire  
9" x 11"

### DIRECTIONAL SIGNAGE

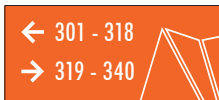

DIR0904 HJ  
1-2 Line Directional  
(Narrow)  
9" x 4"



DIR1204 HJ  
1-2 Line Directional (Wide)  
12" x 4"



DIR1209 HJ  
5-6 Line Directional (Wide)  
12" x 8-3/4"



DIR1211 HJ  
7-8 Line Directional (Wide)  
12" x 11"



DIR0907 HJ  
3-4 Line Directional  
(Narrow)  
9" x 6-1/2"



DIR1207 HJ  
3-4 Line Directional (Wide)  
12" x 6-1/2"

NOTE: Additional sizes of directionals are available if needed.

FORMERLY GRAPHICSSYSTEMS

**IDENTITY GROUP**

# Interior Signage Package

Howard Johnson® by Wyndham

## PARKING AREA SIGNAGE



PRK1218 HJ  
Parking Liability Notice  
12" x 18"



PRK1218B HJ  
Accessible Parking  
12" x 18"



PRK1218C HJ  
Van Accessible Parking  
12" x 18"



VPRK 1218 HJ  
Veteran Reserved Parking  
12" x 18"

USA



Canada - English

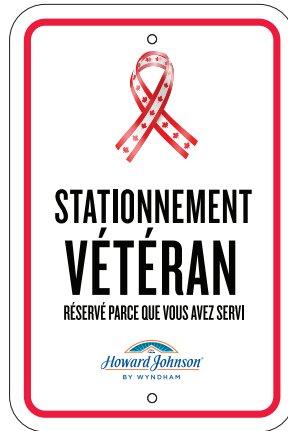

Canada - French



WR PRK 1218  
Wyndham Rewards Reserved Parking  
12" x 18"

# CLEARANCE: 8' - 10"

CLR4208 HJ  
Clearance Height  
42" x 8"

FORMERLY GRAPHICSystems

# IDENTITY GROUP

# Interior Signage Package

Howard Johnson® by Wyndham

## POOL & SPA AREA SIGNAGE

### POOL RULES

1. Pool for guest use only.
2. Food and glass objects are not permitted in pool area.
3. Excessive noise will not be permitted.
4. Pets are not allowed in pool area.
5. Children under 12 years of age must be accompanied by an adult.
6. No running or diving.
7. No lifeguard on duty.
8. Management reserves the right to deny pool usage to anyone at anytime.
9. Use pool at your own risk.

POOL HOURS: 7:00 am to 11:00 pm

POL1622 HJ  
Pool Rules  
16" x 22"

### SPA RULES

1. Spa for guest use only.
2. Food and glass objects are not permitted in spa area.
3. Excessive noise will not be permitted.
4. Pets are not allowed in the spa area.
5. Children under 12 years of age must be accompanied by an adult.
6. CAUTION: Guests with the following conditions should not use the spa without doctor's permission:
  - Heart disease.
  - Diabetic.
  - On medication.
  - Pregnant.
  - High or low blood pressure.
7. Do not exceed 15 minutes continuous in spa.
8. Management reserves the right to deny spa usage to anyone at anytime.
9. Use spa at your own risk.

SPA1622 HJ  
Spa Rules  
16" x 22"

### FITNESS CENTER RULES

1. Individuals utilizing this facility do so at their own risk.
2. It is highly recommended that the following individuals not use the exercise equipment.
  - persons under the influence of alcohol, stimulants or depressants
  - unsupervised children under the age of 16
  - children under the age of 14
3. Should you need any assistance please contact the Front Desk.
4. Equipment should be used in the presence of others.
5. Shoes and appropriate exercising attire are necessary.
6. Smoking is prohibited.
7. Always practice safety and courtesy to others.
8. Report any unsafe conditions to the management.

FIT1622 HJ  
Fitness Center Rules  
16" x 22"

NO LIFEGUARD  
ON DUTY

NLG3212 HJ  
No Lifeguard on Duty  
32" x 12"

NO DIVING



ND3208 HJ  
No Lifeguard on Duty  
32" x 8"

### PLEASE NOTE:

State and local codes may require your pool and spa area signage to have certain text, layouts and copy sizes specific to your area.

If code-related signs are needed for your project, we will quote them in place of the brand standard signs.

FORMERLY GRAPHICSSYSTEMS

**IDENTITY**  
**GROUP**