



GuestHouse

**INTERIOR  
SIGNAGE PACKAGE**

**CONTACT:**

**Amy Scheer**  
316-267-4171 ext. 273  
316-267-6883 FAX  
amy.scheer@identitygroup.com

**We Make Ordering Easy!**

**WAYFINDING**

Send us your hotel's floorplan and let us assist with your signage order. Our experienced wayfinding staff will determine your property's specific requirements and provide you with a detailed plan that includes a graphic of each sign, sign type, quantity, price and location, all in an easy to read format.

**NO MAP CHARGES**

Our professional artists will draw your fire evacuation maps free of charge. Just send us your floorplans and we'll do the rest.

**Guest Room Signage**

**RMN0412D GSH**  
Guest Room Number  
3-Digit  
Left Justified  
3-3/4" x 12-1/4"

**RMN0412C GSH**  
Guest Room Number  
3-Digit  
Right Justified  
3-3/4" x 12-1/4"

**RMN0414D GSH**  
Guest Room Number  
4-Digit  
Left Justified  
3-3/4" x 14-1/4"

**RMN0414C GSH**  
Guest Room Number  
4-Digit  
Right Justified  
3-3/4" x 14-1/4"

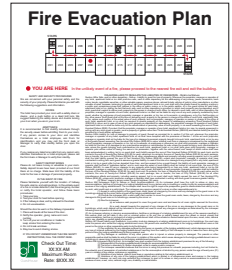
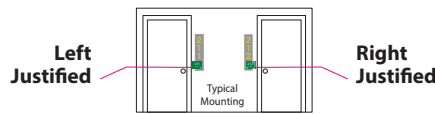

**FEP0911 GSH**  
Guest Room Fire Evacuation Plan With State Lodging Laws  
9" x 11"



**INF0303 CFR**  
Do Not Hang, Contact With Sprinklers Will Cause Flooding  
3" x 3"

**Identification Signage**



**RID0805 GSH**  
1-2 Line ID  
Public Areas  
8" x 4-3/4"



**RID1110 GSH**  
1-2 Line ID With Hours  
Public Areas  
10-3/4" x 9-3/4"



**RES0808 GSH**  
Restroom ID  
Public Areas  
8" x 8"



**MTG0910 GSH**  
Meeting Room ID  
With Insert Holder  
9" x 9-3/4"



**RID0805 GSH- EXT**  
1-2 Line ID  
Back Of House & Exterior Areas  
8" x 4-3/4"



**RID1110 GSH- EXT**  
1-2 Line ID With Hours  
Exterior Areas  
10-3/4" x 9-3/4"



**RID0808 GSH- EXT**  
Restroom ID  
Back Of House & Exterior Areas  
8" x 8"

**Projection Mount Signage**



**PRJ0805 GSH**  
Projection Mount Sign With Symbols  
7-1/2" x 4-3/4"



**PRJ1705 GSH**  
Projection Mount Sign With 2" Copy & Arrow  
16-1/2" x 4-3/4"

**Small Directional Signage**



**DIR0907 GSH**  
1-2 Line Directional  
9" x 6-3/4"



**DIR0909 GSH**  
3-4 Line Directional  
9" x 9-1/4"

**Large Directional Signage**

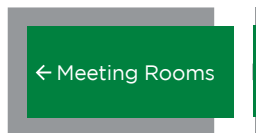

**DIR1207 GSH**  
1-2 Line Directional  
11-3/4" x 6-3/4"



**DIR1209 GSH**  
3-4 Line Directional  
11-3/4" x 9-1/4"



**DIR1212 GSH**  
5-6 Line Directional  
11-3/4" x 11-3/4"



**DIR1214 GSH**  
7-8 Line Directional  
11-3/4" x 14-1/4"

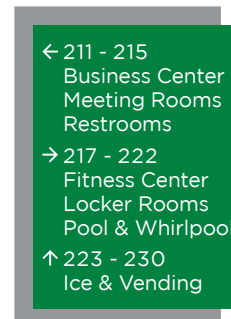

**DIR1217 GSH**  
9-10 Line Directional  
11-3/4" x 16-3/4"

**Owner/Operator Signage**

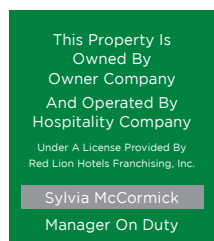

**MOD1112 GSH**  
Owner / Operator & Manager On Duty  
10-3/4" x 12-1/4"



**INS1001 GSH**  
Name Insert For Manager On Duty  
9-1/2" x 1-1/4"

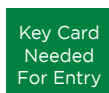

**INF0605 GSH**  
Small Informational Public Areas  
5-1/2" x 4-3/4"



**INF0605 GSH- EXT**  
Small Informational Back Of House & Exterior Areas  
5-1/2" x 4-3/4"



**INF0807 GSH**  
Medium Informational Public Areas  
8" x 7-1/4"

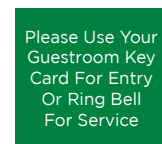

**INF0807 GSH- EXT**  
Medium Informational Back Of House & Exterior Areas  
8" x 7-1/4"

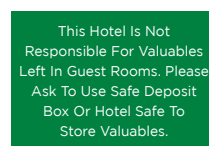

**INF1107 GSH**  
Large Informational Public Areas  
10-3/4" x 7-1/4"



**INF1107 GSH- EXT**  
Large Informational Back Of House & Exterior Areas  
10-3/4" x 7-1/4"

**Podium Signage**



**POD1010 GSH**  
Podium Signage  
10" x 10"



**INF1110 GSH**  
Large Informational With Symbol Public Areas  
10-3/4" x 9-3/4"



**INF1110 GSH- EXT**  
No Smoking Informational Exterior Areas  
10-3/4" x 9-3/4"



**INF1105 GSH**  
This Is A Non-Smoking Floor Informational Public Areas  
10-3/4" x 4-3/4"

**Fire Evacuation & Elevator Signage**



**FEP1112 GSH**  
Corridor/Elevator Evacuation Plan For Ground Level  
10-3/4" x 12-1/4"

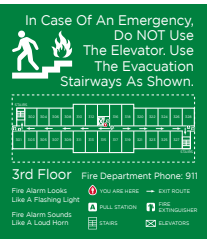

**FEP1112 GSH**  
Corridor/Elevator Evacuation Plan For Upper Floors  
10-3/4" x 12-1/4"



**ELE0304 GSH**  
Elevator Jamb ID  
Public Areas  
3" x 3-1/2"



**ELE0304 GSH- EXT**  
Elevator Jamb ID  
Back Of House & Exterior Areas  
3" x 3-1/2"

**Fitness Center Signage**

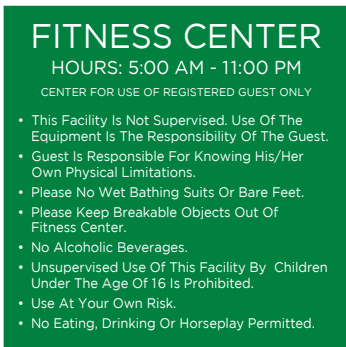

**FIT1818 GSH**  
Fitness Center Rules  
18" x 18"

**Stairwell Signage**



**STR1518 GSH**  
Interior Stairwell Signage  
14-1/2" x 18"



**STR0807 GSH**  
Stairwell ID  
Public Areas  
8" x 7-1/4"

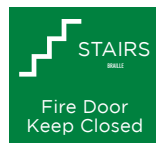

**STR0807 GSH- EXT**  
Stairwell ID  
Back Of House & Exterior Areas  
8" x 7-1/4"



**STR0903 GSH**  
Interior Stairwell ID  
8-1/2" x 3"

**Pool & Whirlpool Signage**



**POL1818 GSH**  
No Diving & No Lifeguard On Duty  
18" x 18"

**RUL1818 GSH**  
Pool & Whirlpool Rules  
18" x 18"

**Exterior Signage**



**PRK1218 GSH**  
Guest Parking  
12" x 18"  
(Post provided  
By Property)



**PRK1218 GSI**  
Accessible  
Parking  
12" x 18"  
(Post provided  
By Property)



**PRK1206**  
Van Accessible  
12" x 6"  
(Post provided  
By Property)

**2300**

**COAXX06 GSH**  
Cut Out Acrylic Characters For Address  
6" Tall Characters



**CLR6010 GSH**  
Clearance Sign  
For Porte Cochère  
60" x 10"