

# CAMBRIA<sup>®</sup> hotels

## INTERIOR SIGNAGE PACKAGE

**CONTACT:**

**Cindy Train**

316-267-4171 ext. 202

316-267-6883 FAX

cindy.train@identitygroup.com

### We Make Ordering Easy!

**WAYFINDING**

Send us your hotel's floorplan and let us assist with your signage order. Our experienced wayfinding staff will determine your property's specific requirements and provide you with a detailed plan that includes a graphic of each sign, sign type, quantity, price and location, all in an easy to read format.

**NO MAP CHARGES**

Our professional artists will draw your fire evacuation maps free of charge. Just send us your floorplans and we'll do the rest.

**PLEASE NOTE:**

Interior signage for Cambria Hotels should reflect the hotel's interior design and overall feel of the brand. This package has been developed with both of those aspects in mind.

*All interior signage is required to meet the Cambria Brand design specifications. All Signage must be reviewed and approved by Brand.*

### Guest Room Signage



**RMN0404S CAM**  
Guest Room Number  
4" x 4"



**SYM0202S CAM**  
Accessible & Hearing Impaired Symbols  
2" x 2"



**INS0503S CAM**  
Rate Card Holder  
4-7/8" x 3-1/8"

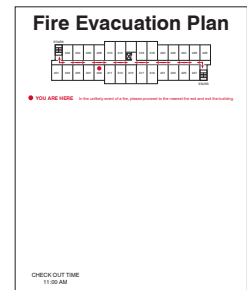

**FEP0911S CAM**  
Guest Room Fire Evacuation Plan  
With State Lodging Laws  
9" x 11"

### Identification Signage



**IDS0706S CAM**  
1-2 Line Small Room ID  
7" x 6"



**IDS1106S CAM**  
1-2 Line Large Room ID  
10-1/2" x 6"



**IDS0706S CAM (EXT)**  
1-2 Line Small  
Exterior/BOH Room ID  
7" x 6"



**IDS1106S CAM (EXT)**  
1-2 Line Large  
Exterior/BOH Room ID  
10-1/2" x 6"



**RES0709S CAM**  
Restroom ID  
7" x 9"



**RES0709S CAM (EXT)**  
Exterior/BOH  
Restroom ID  
7" x 9"



**IDS0709S CAM**  
1-2 Line Small  
Room ID With Hours  
7" x 9"

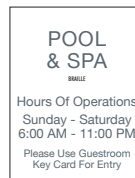

**IDS0709S CAM (EXT)**  
1-2 Line Large Exterior  
Room ID With Hours  
7" x 9"

### Stairwell Signage



**STR0709S CAM**  
Stair ID  
7" x 9"



**STR0709S CAM (EXT)**  
Exterior/BOH Stair ID  
7" x 9"



**STR0903S CAM**  
Interior Stairwell ID  
8-1/2" x 3"

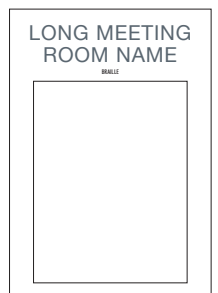

**MTG1115S CAM**  
1-2 Line Meeting Room ID  
With Area For Insert  
10-1/2" x 15"



**SLI1106S CAM**  
Board Room ID With  
In Use/Not In Use Slider  
10-1/2" x 6"

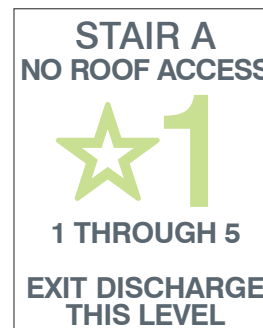

**STR1518S CAM**  
Interior Stairwell  
14-1/2" x 18"

**Directional Signage**

Note: Copy Will Vary Depending On Amenities

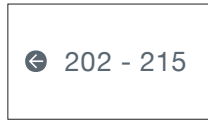

**DIR1106U CAM**  
1-2 Line Small Directional  
10-1/2" x 6"



**DIR1109U CAM**  
3-4 Line Small Directional  
10-1/2" x 9"

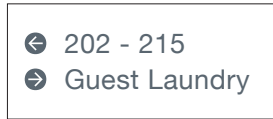

**DIR1406U CAM**  
1-2 Line Large Directional  
14" x 6"

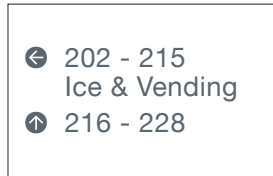

**DIR1409U CAM**  
3-4 Line Large Directional  
14" x 9"

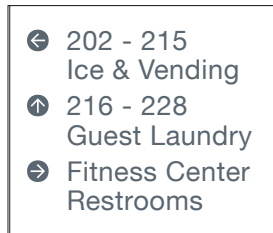

**DIR1412U CAM**  
5-6 Line Large Directional  
14" x 12"

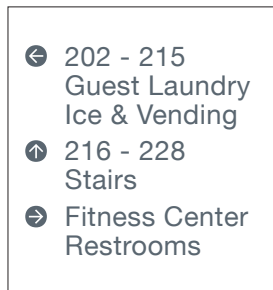

**DIR1415U CAM**  
7-8 Line Large Directional  
14" x 15"

**NOTE: Additional Sizes Of Directional Are Available**

**Elevator/Corridor Signage**

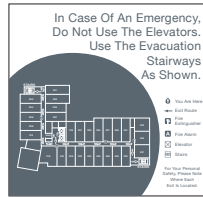

**FEP1110U CAM**  
Fire Evacuation Plan With Map  
10-1/2" x 10"



**ELE0304S CAM**  
Elevator Jamb Numbers  
3" x 3-1/2"



**ELE0401S CAM**  
Directory Buttons For Inside Elevator  
3-1/2" x 1-1/4"

**Projection Mount Signage**



**PRJ0705S CAM**  
Double Sided Restroom Projection Mount  
6-1/2" x 4-1/2"

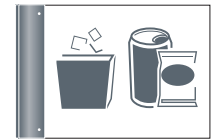

**PRJ0705S CAM**  
Double Sided Ice & Vending Projection Mount  
6-1/2" x 4-1/2"

**Informational Signage**

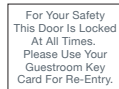

**INF0605S CAM**  
Small Informational  
6" x 4-1/2"  
Note: Copy May Vary



**INF0706S CAM**  
Medium Informational  
7" x 6"  
Note: Copy May Vary



**INF1106S CAM**  
Large Informational  
10-1/2" x 6"  
Note: Copy May Vary

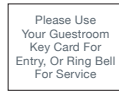

**INF0605S CAM (EXT)**  
Exterior/BOH Small Informational  
6" x 4-1/2"  
Note: Copy May Vary



**INF0706S CAM (EXT)**  
Exterior/BOH Medium Informational  
7" x 6"  
Note: Copy May Vary



**INF1106S CAM (EXT)**  
Exterior/BOH Large Informational  
10-1/2" x 6"  
Note: Copy May Vary



**OWN1109S CAM**  
Owner / Operator  
10-1/2" x 9"

**Fitness Center Signage**



**FIT0404U CAM**  
Closed Caption TV  
4" x 4"



**FIT0401S CAM**  
Please Use Headphones  
3-1/2" x 1-1/4"

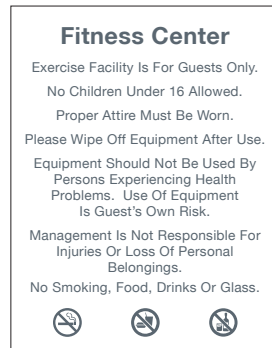

**FIT1418S CAM**  
Fitness Center Rules  
14" x 18"

**Pool & Spa Signage**

Note: Pool & Spa Signage Is Required At All Properties With Pools & Spas

**POOL & SPA RULES**  
Hours: 5:00 AM - 11:00 PM  
Pool & Spa Is For Guest Use Only  
**No Lifeguard On Duty**

- No Children Allowed Under 16 Without Supervision.
- Use Pool At Your Own Risk.
- Management Reserves The Right To Deny Use Of The Pool To Anyone At Any Time.
- Proper Swimwear Required.
- If You Have Health Conditions Requiring Medical Care You Should Consult A Physician Before Entering The Pool.
- Running And Unnecessary Noise Are Not Permitted.
- When In Spa- Long Exposure May Result In Nausea, Dizziness, Or Fainting.
- Hot Water Immersion While Under The Influence Of Alcohol, Narcotics, Drugs Or Medicine May Lead To Serious Consequences And Is Not Recommended.

**Pool Occupancy: 23 Spa Occupancy: 5**

 **No Diving** 

**POL3030S CAM**  
Pool & Spa Rules  
30" x 30"

 **POOL LIFT**

WARNING: To Avoid Risk Of Injury Pool Lift Is For Use By Guests With Disabilities Only. All Other Uses Are Strictly Prohibited.

- Do Not Permit Children To Play On This Product.
- User Shall Assume All Risks And Responsibilities For Safety And Proper Use While Using The Lift.
- Never Operate The Lift With Any Person Within The Operating Range Of The Lift Either On The Deck Or In The Water.
- Never Move The Lift Down While Over The Deck.
- Make Sure The Area Around The Lift Is Clear Before Operating.
- Property Is Not Responsible For Any Injuries Or Damages Suffered Due To The Use Of The Lift, Including Any Improper Methods Used To Exit Or Enter The Lift Chair.

**Please Report Any Unsafe Conditions Or Violations To The Management Immediately.**  
Instructions For Pool Lift Use Located At Front Desk.  
For Assistance With Lift, Please Contact Front Desk.

**LIF2018S CAM**  
Pool Lift Rules  
20" x 18"

**NO LIFEGUARD  
ON DUTY**

**NLG4612S CAM**  
No Lifeguard On Duty  
46" x 12"

**NO  
DIVING** 

**NDV3312S CAM**  
No Diving With Symbol  
33" x 12"

**NOTE: Some State And Local Codes Require Pool & Spa Signage With Copy & Sizes Specific To Your Area. If Code Required Signage Is Needed, It Will Be Quoted Instead Of The Above Standard Signage.**

**Exterior & Parking Signage**

Note: Cambria Vinyl Logos Are Required At All Properties

**CAMBRIA**<sup>®</sup>  
hotel

**LOG2910U CAM**

Vinyl Logos For Entry Door(s)  
28-1/2" x 10-1/8"  
Note: Preferred Placement As Shown Below  
& Mounted On The Outside Of The Glass



Install View - Not To Scale

**CLEARANCE 11'-04"**

**CLR06S CAM**

Cut Out Acrylic Clearance Copy For Porte Cochere  
6" Tall Copy  
Note: Copy May Vary

**6345**

**ADD06S CAM**

Cut Out Acrylic Copy For Address  
6" Tall Copy  
Note: Copy May Vary



**PRK1218S CAM**

Hotel Parking  
12" x 18"  
Note: Post Provided  
By Property



**GSIPRK1218 CAM**

Handicapped Parking  
12" x 18"  
Note: Post Provided  
By Property



**GSIPRK1206 CAM**

Van-Accessible Add-On  
12" x 6"  
Note: Post Provided  
By Property